

10th February 2021

Dear Resident,

Re: Traffic Management on Albemarle Road & Westgate Road Bridge

As you are probably aware, experimental measures to introduce cycle lanes and change traffic management on Albemarle Road have been implemented. Westgate Road bridge has also been made one directional to traffic, with drivers only permitted to drive north (The Avenue) to south (Albemarle Road). The conflicts of drivers coming nose-to-nose on the bridge has long been a matter for concern – well before the nearby cycle route was installed.

These experimental changes were made as part of the Council's long-term ambition to improve cycling and walking links between Bromley and Beckenham. The benefit of experimental schemes is that they can be changed, improved, or removed.

The Council is now consulting with residents on the traffic management of Albemarle Road and traffic flow over Westgate Road bridge.

The options that are being considered are:

- 1) Continue the trial with the introduction of the following 2 amendments –
 - (a) Re-introduce 2-way traffic on Albemarle Road between St Georges and Westgate Road whilst retaining the west to east segregated cycle lane and
 - (b) Re-introduce 2-way traffic onto Westgate Road bridge controlled by the addition of traffic lights (with timings to manage tidal flows) to avoid driver conflicts.
- 2) Revert Albemarle Road and Westgate Road (bridge) to their pre-trial arrangements.

Drawings of option 1 can be found overleaf. If the decision is made to continue the trial further consultation(s) will occur once the impact of the changes has been established. If the decision is made to revert to pre-trial arrangements the changes will be removed, and the experimental project will end, and the Council will be unable to access the funding for signalisation of the Westgate Road bridge as a stand-alone scheme.









The proposed amendments are in response to feedback received and are anticipated to resolve the issues of queuing traffic towards Beckenham Junction, whilst maintaining the core objective of the scheme by providing an attractive option for pedestrians and cyclists alike. The signalisation of the bridge is being proposed to assist with traffic flow, especially at peak hours, and to prevent vehicles coming nose to nose as they cross, which in the past has led to confrontation.

Residents are invited comment on the two proposed options using the following web page – www.bromley.gov.uk/consultations

Comments must be received by 3rd March 2021.

This drawing shall not be used. Changes to be noted on site.
 Any dimensions should be referred to the Engineer prior to work being put in hand.
 This drawing is the property of Waterman Infrastructure & Environmental Limited and the
 drawing is issued on the condition that it is not copied, reproduced, altered or distributed
 in any unauthorised manner, either wholly or in part without the consent in writing of
 the Engineer. For more information contact the Engineer at:
 Project: Water Cycle Street, London SE1 8EQ | 020 7929 7889 | 02033 444 501

GENERAL NOTES

- LEGEND:**
-  PROPOSED CYCLE CONTRAFLOW
 -  PROPOSED YELLOW LINES
 -  PROPOSED WHITE LINES
 -  PROPOSED 1.2m x 0.6m ISLAND PLANTER
 -  PROPOSED KERB
 -  DROPPED KERB
 -  PROPOSED CYCLEROUTE BOLLARD (SEPARATOR)
 -  PROPOSED SIGN
- NOTES:**
1. MANDATORY CYCLE LANE MARKING DIAG. 1057 UNLESS SHOWN OTHERWISE
 2. CYCLE ROUTE BOLLARD POSITION TO BE AGREED ON SITE
 3. NEW / ADJUSTMENTS TO EXISTING WAITING RESTRICTION SIGNAGE NOT SHOWN ON DRAWINGS BUT WILL BE REQUIRED.
 4. SIGN FACE TO BE LOCATED 450mm FROM THE CURB/VANWAY EDGE
 5. ALL SIGNS TO HAVE A MOUNTING HEIGHT OF 2.30m
 6. FOR SIGN POST DETAIL SEE DRAWING:15688-157-WIE-ZZ-XX-DR-C-90107
 7. ALL GULLY GRATES ALONG CYCLE LANE ROUTES TO BE REVIEWED WITH HIGHWAYS AUTHORITY TO AGREE THOSE THAT ARE TO BE REPLACED WITH CYCLE SAFE VERSIONS.
 8. ALL PLANTERS ARE TO BE FITTED WITH REFLECTIVE BANDING AND KEEP LEFT/RIGHT SIGNIFICATION FOR ALL VEHICLE APPROACHES TO SPLIT LOCATION.
 9. ALL SIGNS WITHIN THE PLANTERS MUST PROVIDED 2.3m HEADROOM CLEARANCE.

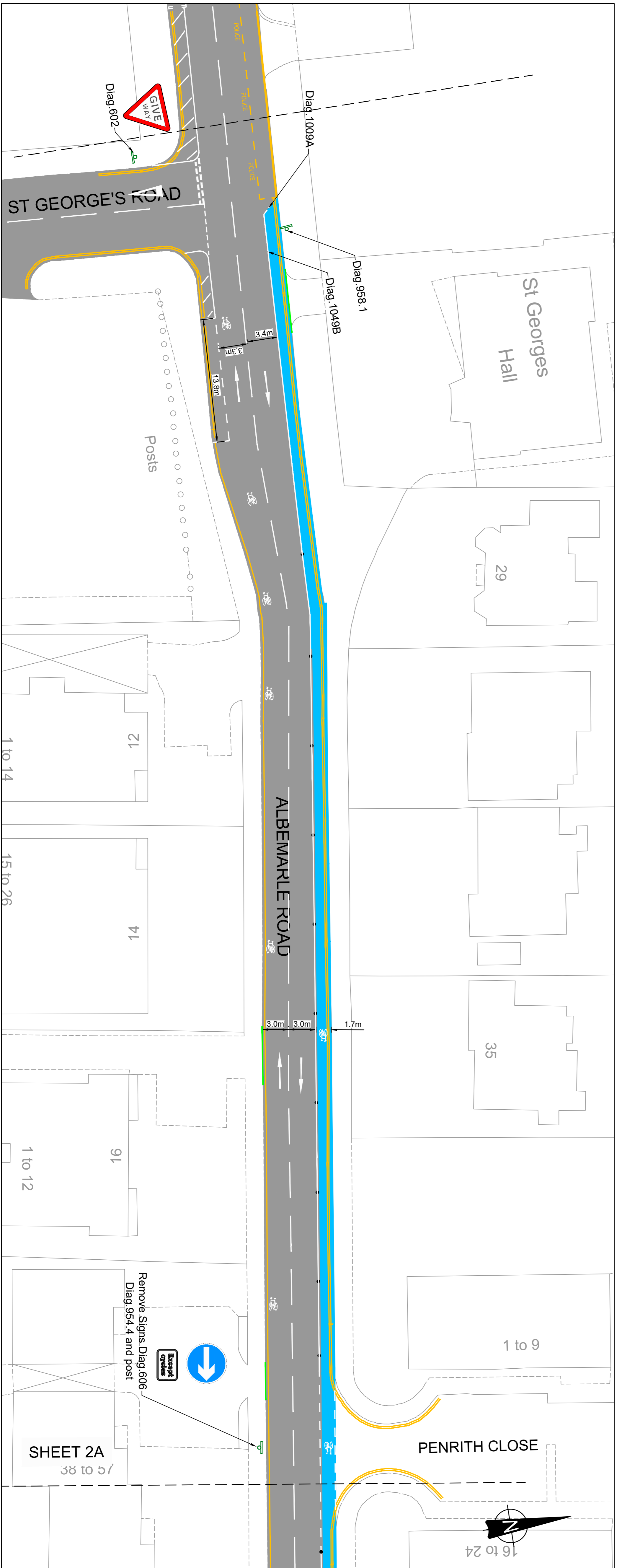
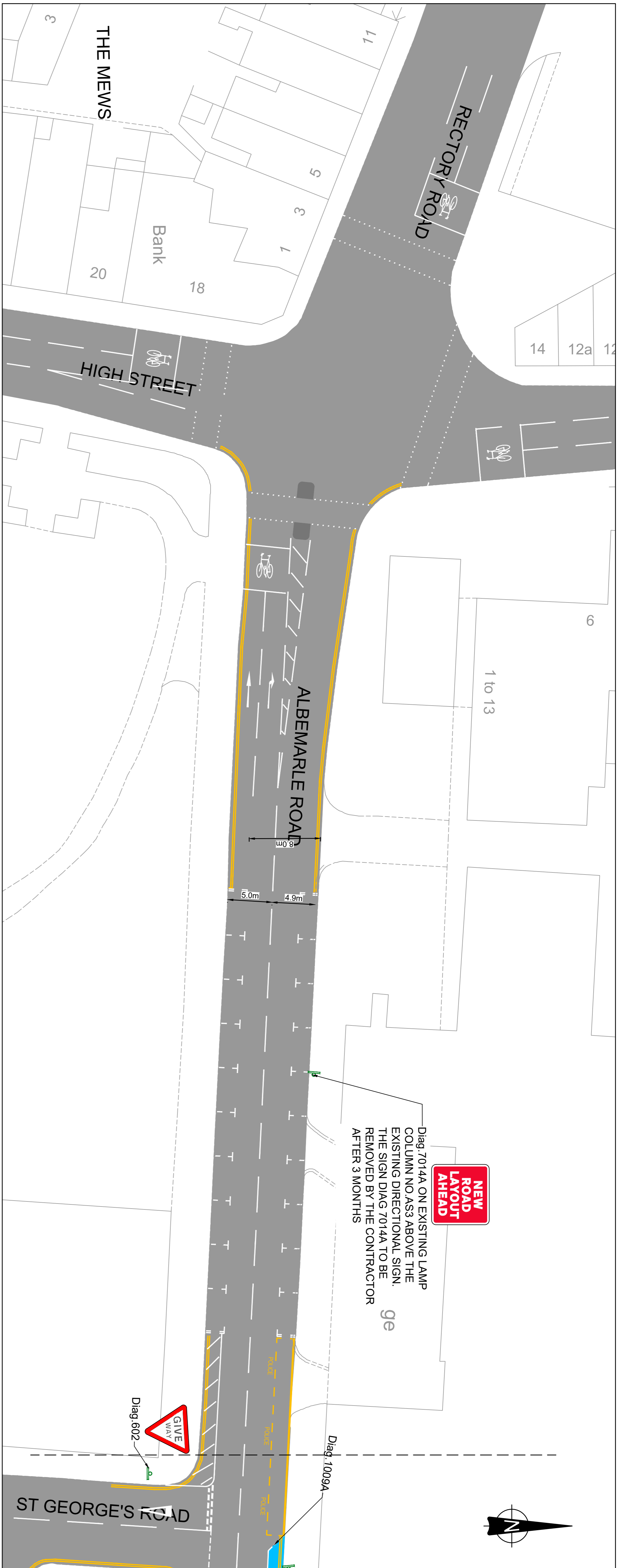

<p>Project: Albemarle Road, Signage</p> <p>Revision:</p> <table border="1" style="width: 100%; border-collapse: collapse;"> <tr> <th>Rev</th> <th>Date</th> <th>Description</th> <th>By</th> </tr> <tr> <td>01</td> <td>01/22</td> <td>PRELIMINARY DESIGN</td> <td>GC</td> </tr> </table>	Rev	Date	Description	By	01	01/22	PRELIMINARY DESIGN	GC	<p>Client:</p> <p>Bromley THE LONDON BOROUGH</p>	<p>Contract:</p> <p>Waterman</p>	<p>Address:</p> <p>Albemarle Road</p> <p>Proposed Layout</p> <p>Sheet 1</p>	<p>Scale:</p> <p>CONSULTATION</p> <p>Drawn By: DG Checked By: SP Date: FEB 21 Scale @ A1: 1:250</p> <p>Project - Owner - Name - Lane - Type - Role - Number</p> <p>15688-165-WIE-ZZ-XX-DR-C-90101 P01</p>
Rev	Date	Description	By									
01	01/22	PRELIMINARY DESIGN	GC									

The drawing should not be scaled. Dimensions to be verified on site.
 Any discrepancies should be referred to the Engineer prior to work being put in hand.
 This drawing is the property of Waterman Infrastructure & Environmental Limited, and the
 information contained herein is confidential. It is to be used only for the project and site
 identified. It is not to be used for any other project or site without the consent in writing of
 Waterman Infrastructure & Environmental Limited.
 Waterman Infrastructure & Environmental Limited, 1000 10th Street, London SE1 8BQ. T: 020 7929 7888 F: 02033 444 551

GENERAL NOTES

- LEGEND:-**
- PROPOSED CYCLE CONTRAFLOW
 - PROPOSED YELLOW LINES
 - PROPOSED WHITE LINES
 - PROPOSED 1.2m x 0.6m ISLAND PLANTER
 - PROPOSED KERB
 - DROPPED KERB
 - PROPOSED CYCLEROUTE BOLLARD (SEPARATOR)
 - PROPOSED SIGN

- NOTES:-**
1. MANDATORY CYCLE LANE MARKING DIAG. 1057 UNLESS SHOWN OTHERWISE
 2. CYCLE ROUTE BOLLARD POSITION TO BE AGREED ON SITE
 3. NEW / ADJUSTMENTS TO EXISTING WAITING RESTRICTION SIGNAGE NOT SHOWN ON DRAWINGS BUT WILL BE REQUIRED.
 4. SIGN FACE TO BE LOCATED 450mm FROM THE CARRIAGEWAY EDGE
 5. ALL SIGNS TO HAVE A MOUNTING HEIGHT OF 2.30m
 6. FOR SIGN POST DETAIL SEE DRAWINGS: 15688-157-WIE-ZZ-XX-DR-C-00107
 7. ALL GULLY GRATES ALONG CYCLE LANE ROUTES TO BE REVIEWED WITH HIGHWAYS AUTHORITY TO AGREE THOSE THAT ARE TO BE REPLACED WITH CYCLE SAFE VERSIONS.
 8. ALL PLANTERS ARE TO BE FITTED WITH REFLECTIVE BANDING AND KEEP LEFT/RIGHT SIGNAGE ON ALL VEHICLE APPROACHES TO SUIT LOCATION.
 9. ALL SIGNS WITHIN THE PLANTERS MUST PROVIDED 2.5m HEADROOM CLEARANCE.

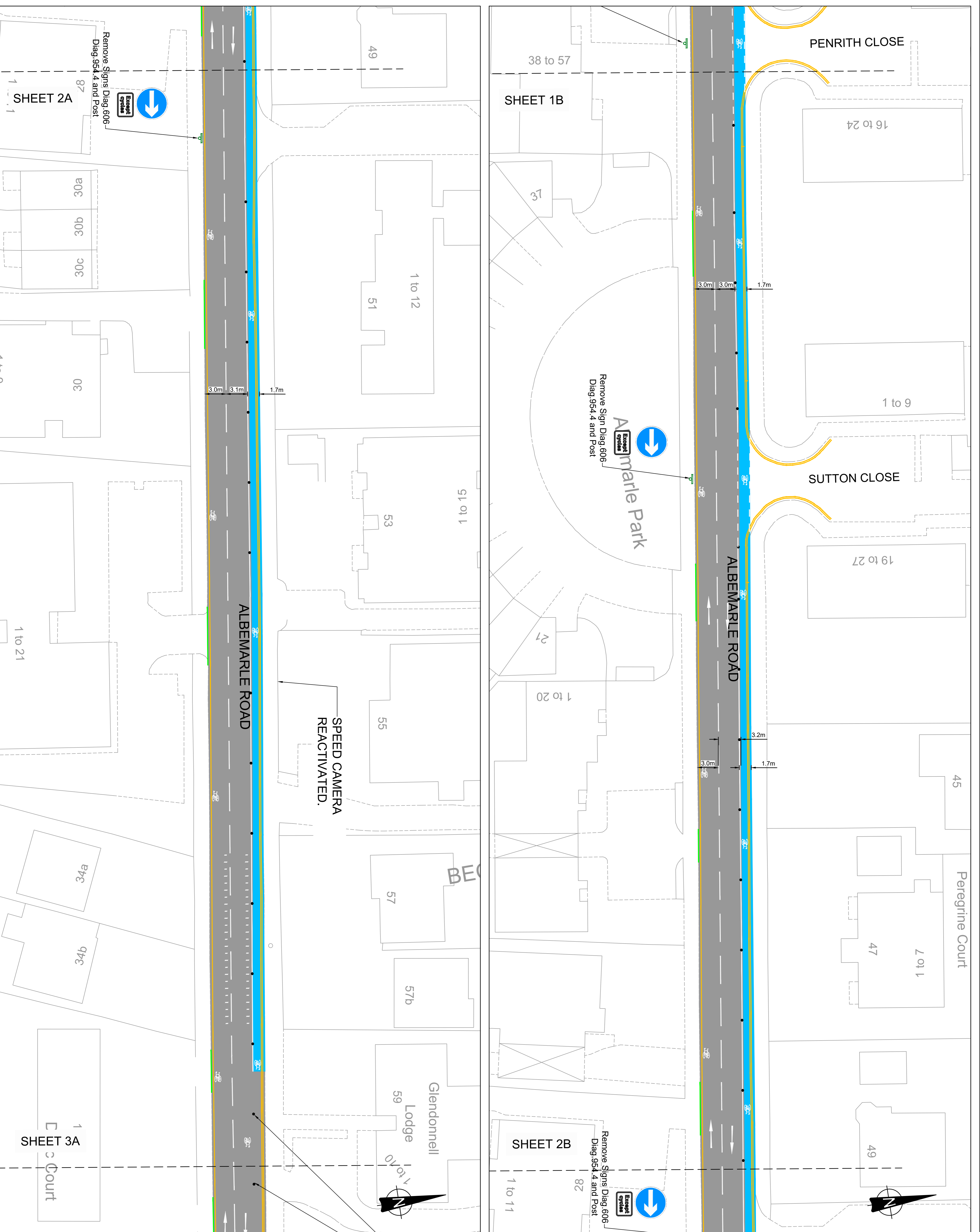

Project: ALBEMARLE ROAD SHEET 2

Client: PROPOSED LAYOUT SHEET 2

Drawn By: DC

Checked By: SP

Date: FEB 21

Scale: @ A1

Revision: 1,250

Project - Output - Volume - Level - Type - Size - Number

15688-165-WIE-ZZ-XX-DR-C-90102 P01

Waterman

Bromley

CONSULTATION

Crown House 2 - 8 Goncaster Road Rehill, Surrey RH1 1FH

151032 283806 | 02033 444 501

ml@watermaninfrastructure.com | www.watermaninfrastructure.com

The drawing should not be scaled. Dimensions to be verified on site.







Any discrepancies should be referred to the engineer prior to work being put in hand.

This drawing is the property of Waterman Infrastructure & Environment Limited, and the user of this drawing is limited to the specific project and site for which it was prepared. It is not to be used for any other project without the written consent of Waterman Infrastructure & Environment Limited.

Waterman Infrastructure & Environment Limited
 Waterman Way, 7, Sun Street, London SE1 1SU. Tel: 0203 7929 7888. Fax: 02033 444 951

GENERAL NOTES

LEGEND:-

-  PROPOSED CYCLE CONTRAFLOW
-  PROPOSED YELLOW LINES
-  PROPOSED WHITE LINES
-  PROPOSED 1.2m x 0.6m ISLAND PLANTER
-  PROPOSED KERB
-  DROPPED KERB (SEPARATOR) PROPOSED SIGN

NOTES:-

1. MANDATORY CYCLE LANE MARKING DIAG. 1057 UNLESS SHOWN OTHERWISE
2. CYCLE ROUTE BOLLARD POSITION TO BE AGREED ON SITE
3. NEW / ADJUSTMENTS TO EXISTING WAITING RESTRICTION SIGNAGE NOT SHOWN ON DRAWINGS BUT WILL BE REQUIRED.
4. SIGN FACE TO BE LOCATED 450mm FROM THE CARRIAGEWAY EDGE
5. ALL SIGNS TO HAVE A MOUNTING HEIGHT OF 2.30m
6. FOR SIGN POST DETAIL SEE DRAWING: 15688-165-WIE-ZZ-XX-DR-C-90107
7. ALL GULLY GRATES ALONG CYCLE LANE ROUTES TO BE REVIEWED WITH HIGHWAYS AUTHORITY TO AGREE THOSE THAT ARE TO BE REPLACED WITH CYCLE SAFE VERSIONS.
8. ALL PLANTERS ARE TO BE FITTED WITH REFLECTIVE BANDING AND KEEP LEFT/RIGHT SIGNAGE ON ALL VEHICLE APPROACHES TO SUIT LOCATION.
9. ALL SIGNS WITHIN THE PLANTERS MUST PROVIDED 2.5m HEADROOM CLEARANCE.

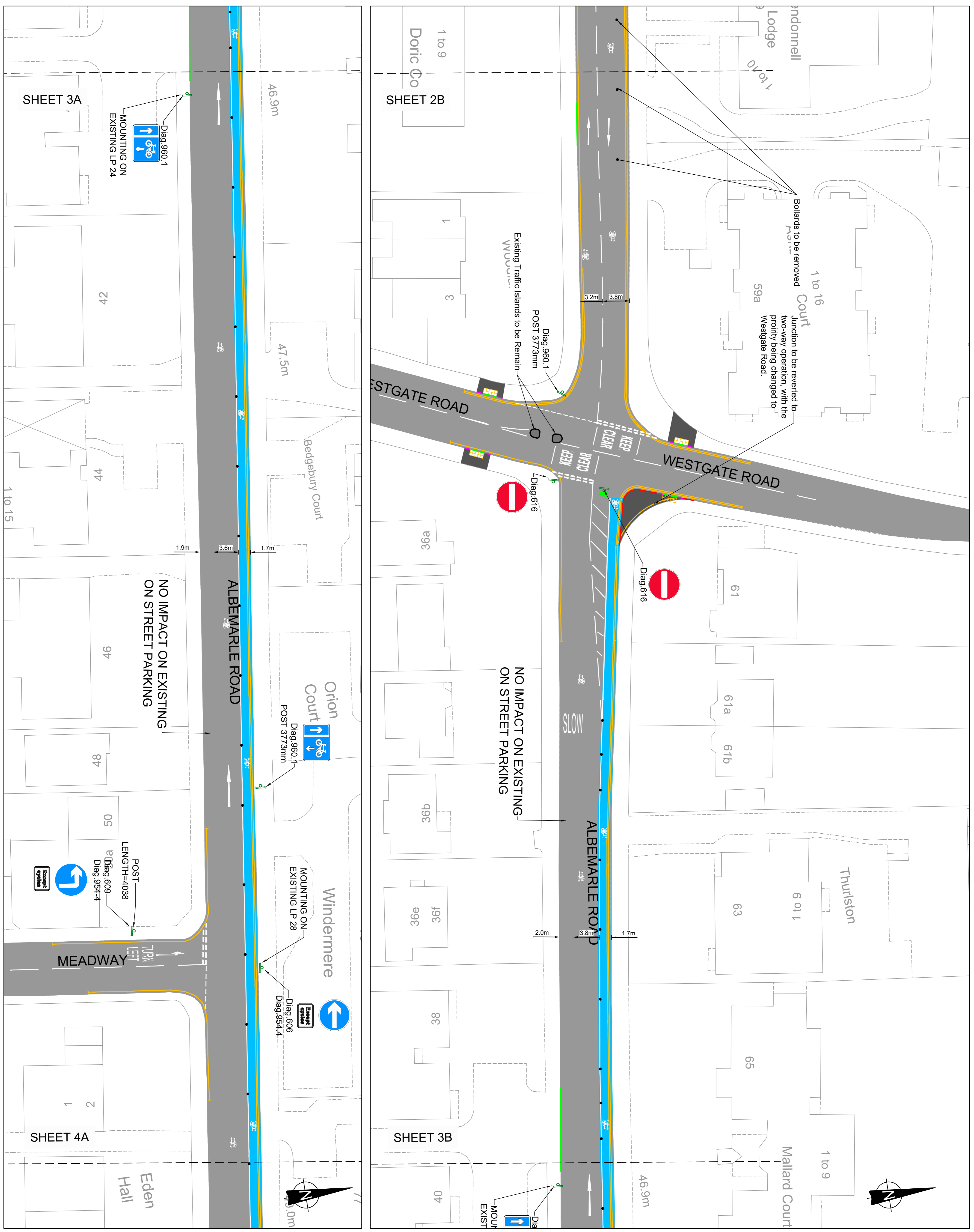

Project	ALBEMARLE ROAD
Revision	05
Drawn By	010221 PRELIMINARY DESIGN
Checked By	
Date	
Description	
By	

Project	ALBEMARLE ROAD
Revision	05
Drawn By	010221 PRELIMINARY DESIGN
Checked By	
Date	
Description	
By	

Project	ALBEMARLE ROAD
Revision	05
Drawn By	010221 PRELIMINARY DESIGN
Checked By	
Date	
Description	
By	

Project	ALBEMARLE ROAD
Revision	05
Drawn By	010221 PRELIMINARY DESIGN
Checked By	
Date	
Description	
By	

Project	ALBEMARLE ROAD
Revision	05
Drawn By	010221 PRELIMINARY DESIGN
Checked By	
Date	
Description	
By	

Project	ALBEMARLE ROAD
Revision	05
Drawn By	010221 PRELIMINARY DESIGN
Checked By	
Date	
Description	
By	

Project	ALBEMARLE ROAD
Revision	05
Drawn By	010221 PRELIMINARY DESIGN
Checked By	
Date	
Description	
By	

Project	ALBEMARLE ROAD
Revision	05
Drawn By	010221 PRELIMINARY DESIGN
Checked By	
Date	
Description	
By	

Project	ALBEMARLE ROAD
Revision	05
Drawn By	010221 PRELIMINARY DESIGN
Checked By	
Date	
Description	
By	

Project	ALBEMARLE ROAD
Revision	05
Drawn By	010221 PRELIMINARY DESIGN
Checked By	
Date	
Description	
By	

Project	ALBEMARLE ROAD
Revision	05
Drawn By	010221 PRELIMINARY DESIGN
Checked By	
Date	
Description	
By	

Project	ALBEMARLE ROAD
Revision	05
Drawn By	010221 PRELIMINARY DESIGN
Checked By	
Date	
Description	
By	

Project	ALBEMARLE ROAD
Revision	05
Drawn By	010221 PRELIMINARY DESIGN
Checked By	
Date	
Description	
By	

Project	ALBEMARLE ROAD
Revision	05
Drawn By	010221 PRELIMINARY DESIGN
Checked By	
Date	
Description	
By	

Project	ALBEMARLE ROAD
Revision	05
Drawn By	010221 PRELIMINARY DESIGN
Checked By	
Date	
Description	
By	

Project	ALBEMARLE ROAD
Revision	05
Drawn By	010221 PRELIMINARY DESIGN
Checked By	
Date	
Description	
By	

Project	ALBEMARLE ROAD
Revision	05
Drawn By	010221 PRELIMINARY DESIGN
Checked By	
Date	
Description	
By	

Project	ALBEMARLE ROAD
Revision	05
Drawn By	010221 PRELIMINARY DESIGN
Checked By	
Date	
Description	
By	

Project	ALBEMARLE ROAD
Revision	05
Drawn By	010221 PRELIMINARY DESIGN
Checked By	
Date	
Description	
By	

Project	ALBEMARLE ROAD
Revision	05
Drawn By	010221 PRELIMINARY DESIGN
Checked By	
Date	
Description	
By	

Project	ALBEMARLE ROAD
Revision	05
Drawn By	010221 PRELIMINARY DESIGN
Checked By	
Date	
Description	
By	

Project	ALBEMARLE ROAD
Revision	05
Drawn By	010221 PRELIMINARY DESIGN
Checked By	
Date	
Description	
By	

Project	ALBEMARLE ROAD
Revision	05
Drawn By	010221 PRELIMINARY DESIGN
Checked By	
Date	
Description	
By	

Project	ALBEMARLE ROAD
Revision	05
Drawn By	010221 PRELIMINARY DESIGN
Checked By	
Date	
Description	
By	

Project	ALBEMARLE ROAD
Revision	05
Drawn By	010221 PRELIMINARY DESIGN
Checked By	
Date	
Description	
By	

Project	ALBEMARLE ROAD
Revision	05
Drawn By	010221 PRELIMINARY DESIGN
Checked By	
Date	
Description	
By	

Project	ALBEMARLE ROAD
Revision	05
Drawn By	010221 PRELIMINARY DESIGN
Checked By	
Date	
Description	
By	

Project	ALBEMARLE ROAD
Revision	05
Drawn By	010221 PRELIMINARY DESIGN
Checked By	
Date	
Description	
By	

Project	ALBEMARLE ROAD
Revision	05
Drawn By	010221 PRELIMINARY DESIGN
Checked By	
Date	
Description	
By	

Project	ALBEMARLE ROAD
Revision	05
Drawn By	010221 PRELIMINARY DESIGN
Checked By	
Date	
Description	
By	

Project	ALBEMARLE ROAD
Revision	05
Drawn By	010221 PRELIMINARY DESIGN
Checked By	
Date	
Description	
By	

Project	ALBEMARLE ROAD
Revision	05
Drawn By	010221 PRELIMINARY DESIGN
Checked By	
Date	
Description	
By	

Project	ALBEMARLE ROAD
Revision	05
Drawn By	010221 PRELIMINARY DESIGN
Checked By	
Date	
Description	
By	

Project	ALBEMARLE ROAD
Revision	05
Drawn By	010221 PRELIMINARY DESIGN
Checked By	
Date	
Description	
By	

Project	ALBEMARLE ROAD
Revision	05
Drawn By	010221 PRELIMINARY DESIGN
Checked By	
Date	
Description	
By	

Project	ALBEMARLE ROAD
Revision	05
Drawn By	010221 PRELIMINARY DESIGN
Checked By	
Date	
Description	
By	

Project	ALBEMARLE ROAD
Revision	05
Drawn By	010221 PRELIMINARY DESIGN
Checked By	
Date	
Description	
By	

Project	ALBEMARLE ROAD
Revision	05
Drawn By	010221 PRELIMINARY DESIGN
Checked By	
Date	
Description	
By	

Project	ALBEMARLE ROAD
Revision	05
Drawn By	010221 PRELIMINARY DESIGN
Checked By	
Date	
Description	
By	

Project	ALBEMARLE ROAD
Revision	05
Drawn By	010221 PRELIMINARY DESIGN
Checked By	
Date	
Description	
By	

Project	ALBEMARLE ROAD
Revision	05
Drawn By	010221 PRELIMINARY DESIGN
Checked By	
Date	
Description	
By	

Project	ALBEMARLE ROAD
Revision	05
Drawn By	010221 PRELIMINARY DESIGN
Checked By	
Date	
Description	
By	

Project	ALBEMARLE ROAD
Revision	05
Drawn By	010221 PRELIMINARY DESIGN
Checked By	
Date	
Description	
By	

Project	ALBEMARLE ROAD
Revision	05
Drawn By	010221 PRELIMINARY DESIGN
Checked By	
Date	
Description	
By	

Project	ALBEMARLE ROAD
Revision	05
Drawn By	010221 PRELIMINARY DESIGN
Checked By	
Date	
Description	
By	

Project	ALBEMARLE ROAD
Revision	05
Drawn By	010221 PRELIMINARY DESIGN
Checked By	
Date	
Description	
By	

Project	ALBEMARLE ROAD
Revision	05
Drawn By	010221 PRELIMINARY DESIGN
Checked By	
Date	
Description	
By	

Project	ALBEMARLE ROAD
Revision	05
Drawn By	010221 PRELIMINARY DESIGN
Checked By	
Date	
Description	
By	

Project	ALBEMARLE ROAD
Revision	05
Drawn By	010221 PRELIMINARY DESIGN
Checked By	
Date	
Description	
By	

Project	ALBEMARLE ROAD
Revision	05
Drawn By	010221 PRELIMINARY DESIGN
Checked By	
Date	
Description	
By	

Project	ALBEMARLE ROAD
Revision	05
Drawn By	010221 PRELIMINARY DESIGN
Checked By	
Date	
Description	
By	

Project	ALBEMARLE ROAD
Revision	